



Sprinter

Speed Delivery Door Supplement



9075848009

Order no. T907 0380 13 Part no. 907 584 80 09 Edition 2021-07

Mercedes-Benz



Publication details

Internet

Further information about Mercedes-Benz vehicles and about Mercedes-Benz AG can be found on the following websites:

<https://www.mercedes-benz.com>

<https://www.daimler.com>

Documentation team

You are welcome to forward any queries or suggestions you may have regarding this Supplement to the technical documentation team at the following address:

Mercedes-Benz AG, HPC: CAC, Customer Service,
70546 Stuttgart, Germany

©Mercedes-Benz AG: not to be reprinted, translated or otherwise reproduced, in whole or in part, without written permission from Mercedes-Benz AG.

Vehicle manufacturer

Mercedes-Benz AG

Mercedesstraße 120

70372 Stuttgart

Germany

Symbols 2

Speed Delivery Door 3

Notes on the Speed Delivery Door 3

Function of the Speed Delivery Door 3

Automatically opening or closing the

Speed Delivery Door 4

Manually opening or closing the Speed

Delivery Door 5

Resetting the Speed Delivery Door 6

Index 7

In this Supplement, you will find the following symbols:

 **DANGER** Danger due to not observing the warning notices

Warning notices draw your attention to hazards that may endanger your health or life, or the health or life of others.

► Observe the warning notices.

 **ENVIRONMENTAL NOTE** Environmental damage due to failure to observe environmental notes

Environmental notes include information on environmentally responsible behavior or environmentally responsible disposal.

► Observe environmental notes.

 **NOTE** Damage to property due to failure to observe notes on material damage

Notes on material damage inform you of risks which may lead to your vehicle being damaged.

► Observe notes on material damage.

 These symbols indicate useful instructions or further information that could be helpful to you.

► Instructions

(→ Further information on a topic page)

Display Display in the multifunction display/media display

* Indicates a cause

Notes on the Speed Delivery Door

- ⚠ WARNING** Risk of injury when opening and closing the Speed Delivery Door

Parts of the body could become trapped. There may be people in the closing area.

Persons in the swinging range of the Speed Delivery Door may be struck by the door.

- ▶ Make sure that nobody is in the vicinity of the closing area during the closing process.
- ▶ Keep a sufficient safe distance when opening and closing.

- ⚠ WARNING** Risk of accident due to opening the Speed Delivery Door

When the Speed Delivery Door is opened, other people or road users can be hit by the Speed Delivery Door as it swings outwards.

A person may be struck by oncoming traffic when getting out of the vehicle.

- ▶ Always pay careful attention to the traffic situation.
- ▶ Only open the Speed Delivery Door when traffic conditions permit.

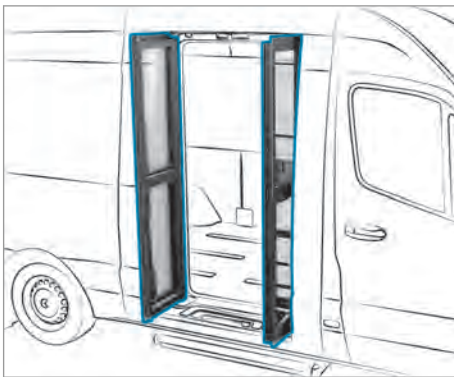

The Speed Delivery Door enables fast and ergonomic entry and exit of the cargo compartment.

Optionally, your vehicle can be equipped with an automatic locking mechanism.

- ⓘ For vehicles with ATA (anti-theft alarm system with interior motion sensor), the automatic locking mechanism function is not available.

Observe the following when using the Speed Delivery Door with automatic locking mechanism:

- When the vehicle is switched off and you get out of the vehicle, the vehicle will lock automatically after the exterior doors are closed.
- Always take the key with you when you leave the vehicle. Otherwise, you can lock yourself out.

Also observe the vehicle Operating Instructions.

Function of the Speed Delivery Door

To use the Speed Delivery Door, the following requirements must be met:

- The vehicle is stationary.
- The vehicle is switched off.

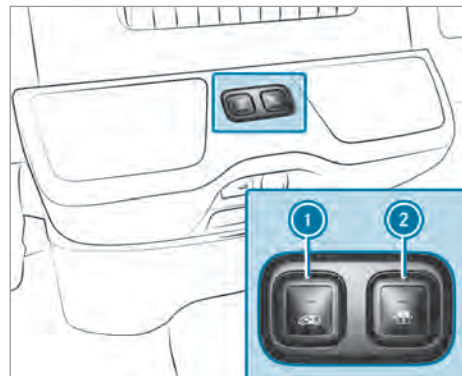

Buttons in the cockpit

You can select the following functions using buttons ② in the cockpit or on the Speed Delivery Door:

- Automatic operation (→ page 4)
- Manual operation

When the Speed Delivery Door is operational, automatic operation is always activated and the indicator lamps of buttons ② light up.

When automatic operation is deactivated, the photoelectric sensors are disabled and the indicator lamps of buttons ② are off. To switch back to automatic mode, press button ② in the cockpit or on the Speed Delivery Door.

Use button ① to open or close the Speed Delivery Door. While the Speed Delivery Door is opening or closing, the indicator lamp of button ① flashes. When the process is complete and the Speed

Delivery Door is open, the indicator lamp on button ❶ lights up.

- ❶ Vehicles with automatic locking mechanism: a short time after closing the Speed Delivery Door, the interior lighting in the cargo compartment and in the driver's cab is switched off. Always take the key with you when you leave the vehicle. Otherwise, you can lock yourself out.
- ❷ When you start the vehicle, the Speed Delivery Door closes automatically regardless of the function selected.

Automatic operation

In automatic mode, the Speed Delivery Door opens or closes by triggering the photoelectric sensors.



Photoelectric sensor on the sliding partition door

When you open the sliding partition door and enter the cargo compartment, the Speed Delivery Door is opened by triggering the photoelectric sensor.

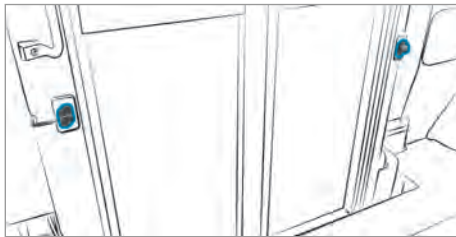

Photoelectric sensor on the Speed Delivery Door

When you exit the cargo compartment through the Speed Delivery Door, it closes automatically after about four seconds.

Vehicles with automatic locking mechanism: the vehicle is locked.

When you return to the vehicle, use the key to unlock the vehicle and open the Speed Delivery Door.

Manual operation

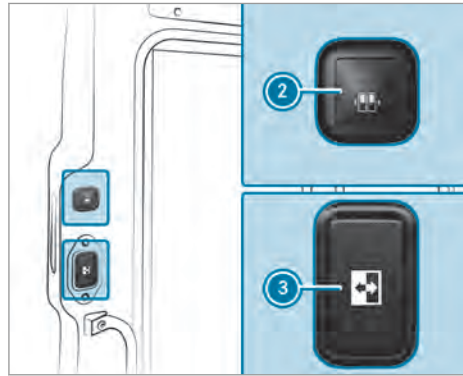

Buttons on the Speed Delivery Door

Use button ❸ to open or close the Speed Delivery Door regardless of the operating status.

Automatically opening or closing the Speed Delivery Door

Requirements:

- The vehicle is stationary.
- The vehicle is switched off.
- Automatic operation is activated.

▶ Put the key away, for example in your trouser pocket.

❶ Vehicles with automatic locking mechanism: always take the key with you when leaving the vehicle. Otherwise, you can lock yourself out.

▶ **To open:** open the sliding partition door and enter the cargo compartment. The Speed Delivery Door opens automatically.

▶ **To exit and close the cargo compartment:** exit the cargo compartment through the Speed Delivery Door. The Speed Delivery Door closes automatically after approximately four seconds.

Vehicles with automatic locking mechanism: the vehicle is locked.

❷ When the vehicle is locked automatically or is locked using the  button on the key, make sure the vehicle's turn signal lamps flash three times. Otherwise, the vehicle is not properly locked.



- ▶ **To open and enter the cargo compartment:** press and hold the  button on the key for at least one second. The Speed Delivery Door opens and, after approximately two seconds, is automatically closed again after you enter the cargo compartment.

Manually opening or closing the Speed Delivery Door

Requirements:

- The vehicle is stationary.
- The vehicle is switched off.

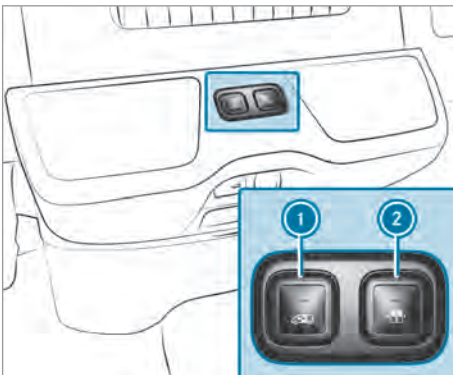

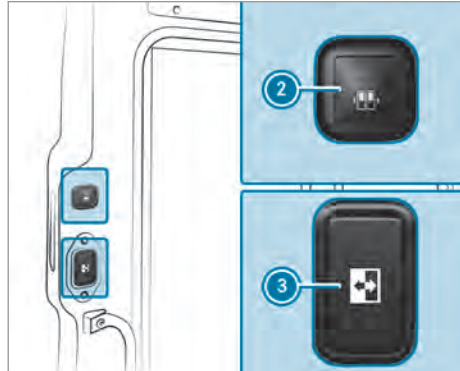

Buttons in the cockpit



Buttons on the Speed Delivery Door

- ▶ Press button **2** in the cockpit or on the Speed Delivery Door. Automatic operation is deactivated and the indicator lamps on buttons **2** are off.
- ▶ Put the key away, for example in your trouser pocket.
- ⓘ Vehicles with automatic locking mechanism: always take the key with you when leaving the vehicle. Otherwise, you can lock yourself out.
- ▶ **To open:** press button **1** in the cockpit.
- or
- ▶ Press button **3** on the Speed Delivery Door.



- ▶ **To exit and close the cargo compartment:** exit the cargo compartment through the Speed Delivery Door and press the  button on the key. Vehicles with automatic locking mechanism: the vehicle is locked.
- ⓘ When the vehicle is locked automatically or is locked using the  button on the key, make sure the vehicle's turn signal lamps flash three times. Otherwise, the vehicle is not properly locked.

▶ **To open and enter the cargo compartment:**
press and hold the  button on the key for at least one second.

▶ **To close:** press button  on the Speed Delivery Door.

or

▶ Press button  in the cockpit.

or

▶ Start the vehicle.

Resetting the Speed Delivery Door

Requirements:

- The vehicle is stationary.
- The vehicle is switched off.

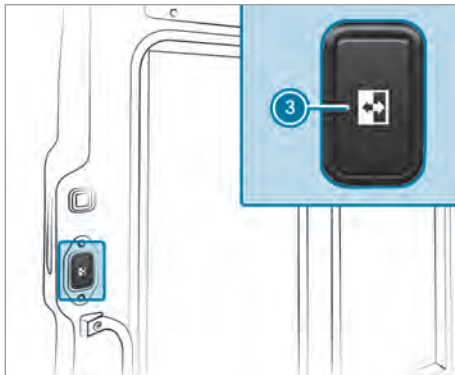

Button on the Speed Delivery Door

If the symbol of button  flashes rapidly, for example after a malfunction or a voltage supply interruption, you must reset the Speed Delivery Door.

▶ If the Speed Delivery Door is open: press and hold button  until the Speed Delivery Door is completely closed.

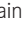
▶ Briefly press button  again.
The Speed Delivery Door opens and closes automatically. When the process has been completed, the Speed Delivery Door is operational.

S**Speed Delivery Door**

Automatically opening/closing.....	4
Function.....	3
Manually opening/closing.....	5
Notes.....	3
Resetting.....	6

